

Installation Guide For Rear View Camera

BRIGADE®

Do not connect/disconnect rear view camera while the main dash cam unit is powered on and in operation as it may damage the dash cam and/or the rear view camera. Turn the device off completely before connecting or disconnecting the rear view camera.

1. Remove the protective film from the camera.

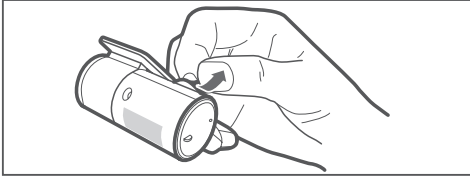

2. Clean the area on the rear windshield where the rearview camera will be installed. Remove the protective tape from the adhesive on the mount and attach the camera at the center of rear window where it has an unobstructed rear view of the vehicle but does not interfere with the driver's view when looking at the rear view mirror.

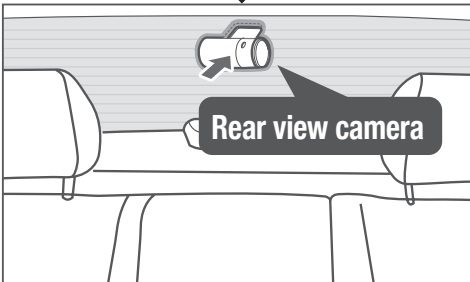
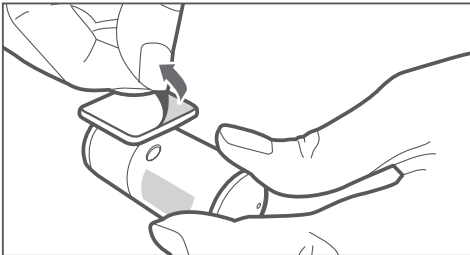

3. Adjust the rearview camera so that it is facing backward on the rear window towards back of the car and level with the vehicle and the road.

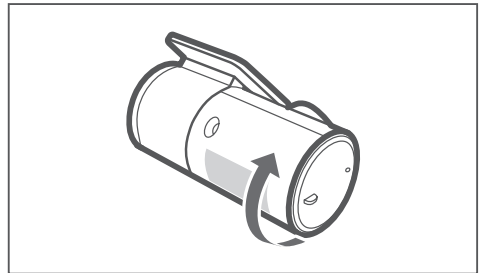

4. Using the cable included in the package, connect the rearview camera to the V-IN port of the main dash cam unit.

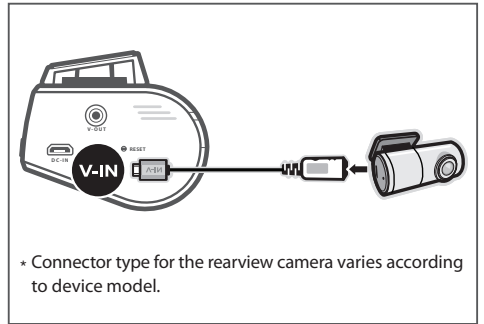

- In order to ensure the correct orientation of the camera and to prevent the video from being flipped upside down, connect rearview camera to the main dash cam unit to start recording sample videos which can be used to check the camera orientation.
- The rearview camera will operate only when the cable is correctly connected and the power for the main unit is ON.

- www.brigade-electronics.com provides various reference materials in order to assist with rearview camera installation. Please visit the Product Support Area of the website.
- Brigade Electronics is not responsible for damages to the main unit and/or any attached accessories due to improper user installations. Brigade Electronics strongly recommends professional automotive installation service to avoid such damages.

This device complies with part 15 of the FCC Rules.

Operation is subject to the following two conditions:

- (1) This device may not cause harmful interference, and
- (2) This device must accept any interference received, including interference that may cause undesired operation.

FCC Compliance Statement

Note: This equipment has been tested and found to comply with the limits for a Class B digital device, pursuant to part 15 of the FCC Rules.

These limits are designed to provide reasonable protection against harmful interference in a residential installation

This equipment generates, uses and can radiate radio frequency energy and, if not installed and used in accordance with the instructions, may cause harmful interference to radio communications. However, there is no guarantee that interference will not occur in a particular installation. If this equipment does cause harmful interference to radio or television reception, which can be determined by turning the equipment off and on, the user is encouraged to try to correct the interference by one or more of the following measures:

- Reorient or relocate the receiving antenna.
- Increase the separation between the equipment and receiver.
- Connect the equipment into an outlet on a circuit different from that to which the receiver is connected.
- Consult the dealer or an experienced radio/TV technician for help.

Caution: Any changes or modifications to the equipment not expressly approved by the party responsible for compliance could void your authority to operate the equipment.

Note: This unit was tested with shielded cables on the peripheral devices. Shielded cables must be used with the unit to insure compliance.

This Class B digital apparatus complies with Canadian ICES-003

